

ASSEMBLY INSTRUCTIONS

KIEL TABLE COLLECTION DINING TABLE

Please read instructions carefully. Remove all wrapping material and packing from the carton. See hardware and furniture parts list for guidance. Be sure you have all parts before you start to assemble the product. Place all furniture parts on a clean surface, such as carpet or rug to prevent the item from being scratched.

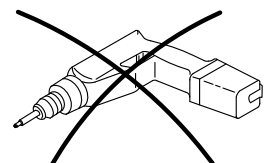
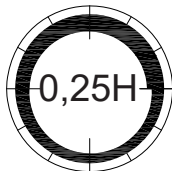
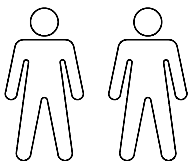
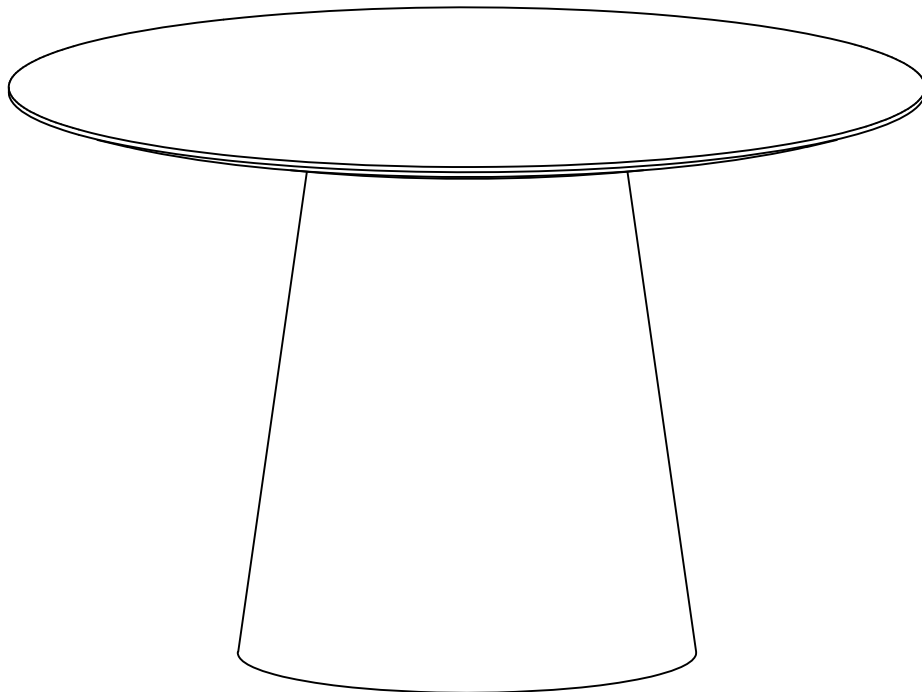

Part list:

1 x Part 1

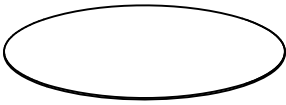

Top

1 x Part 2



Top Base

1 x Part 3

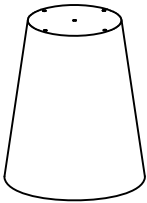

Leg Base

Hardware list:

Ax4

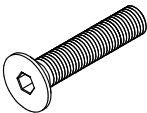

Bolt
M8x35

Bx4

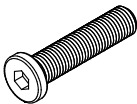

Bolt
M8x35

Cx4

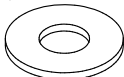

Washer
Ø8/Ø18

Dx1

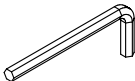

Allen key
5mm

Ex8



Felt Pad
Ø40x4

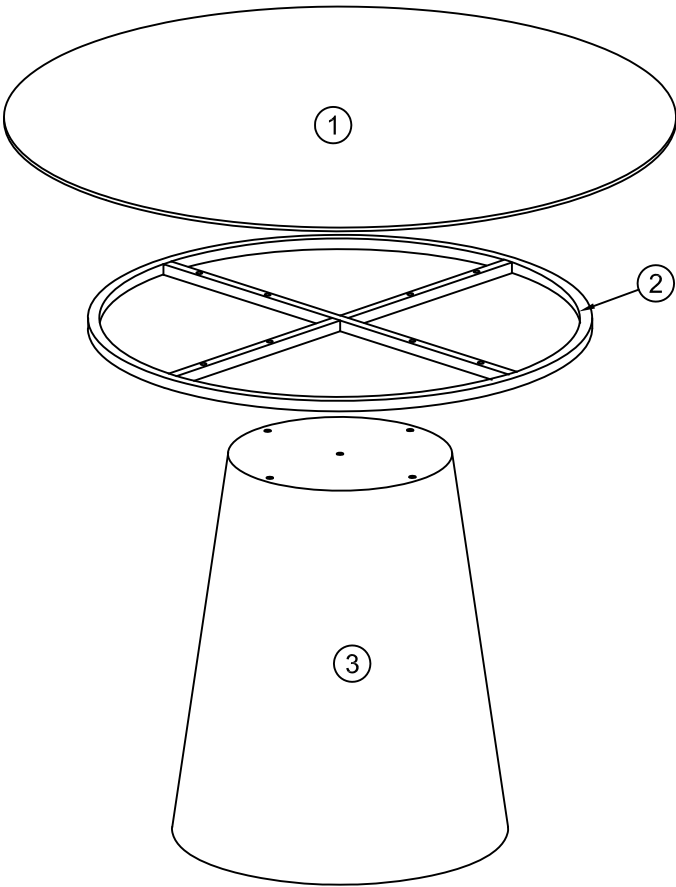

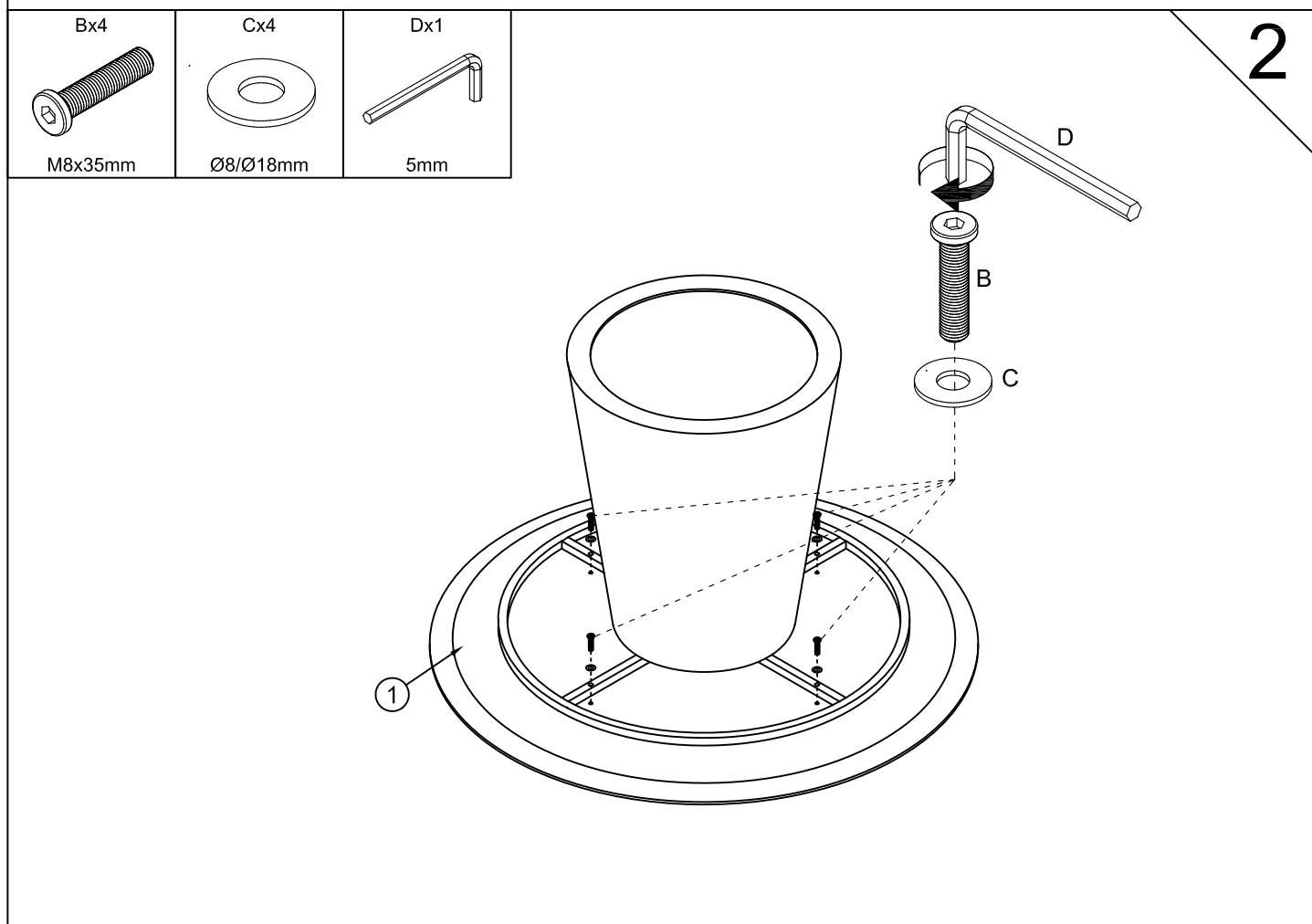
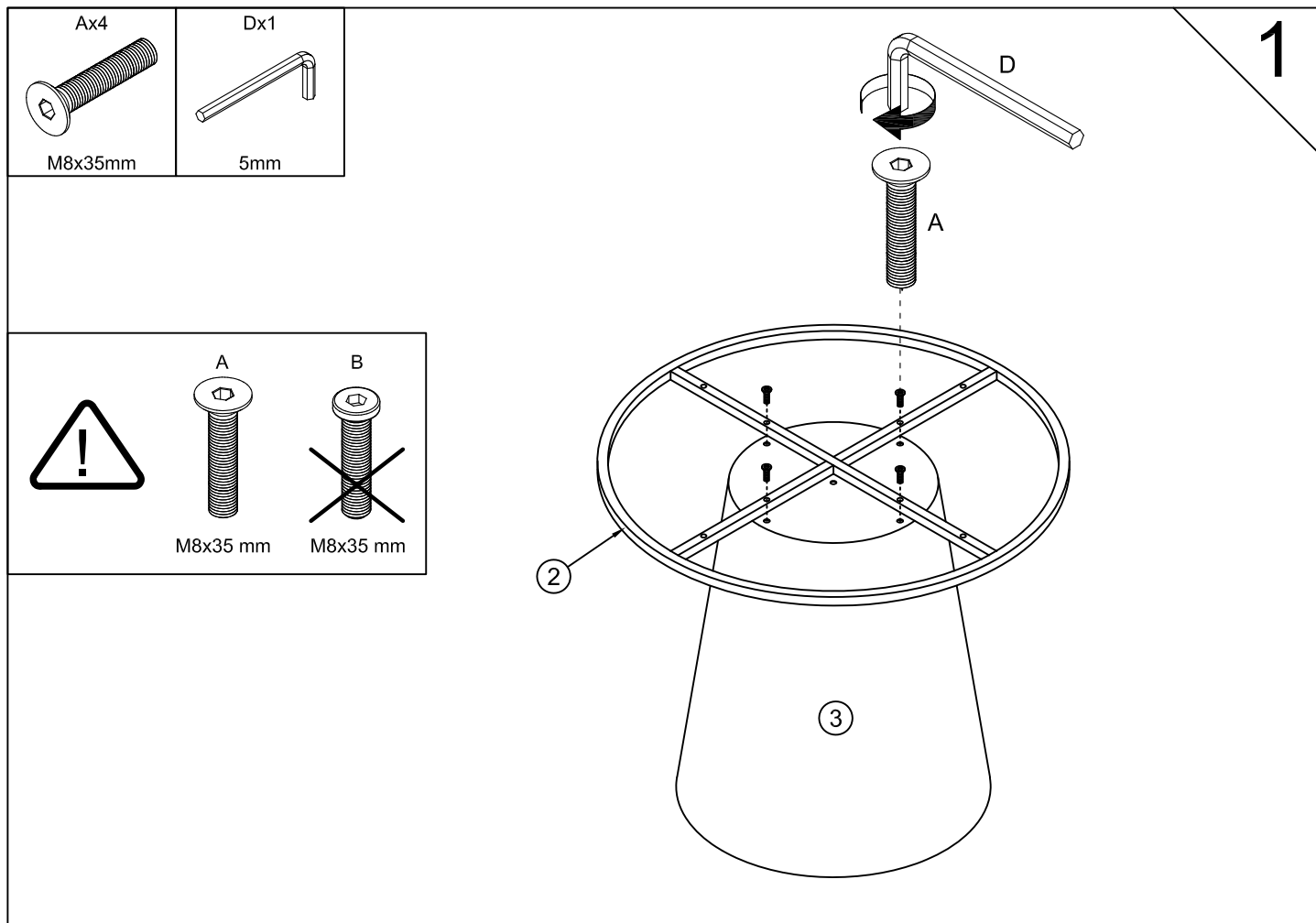

Ex8



Ø40x4mm



E

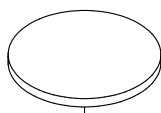

3

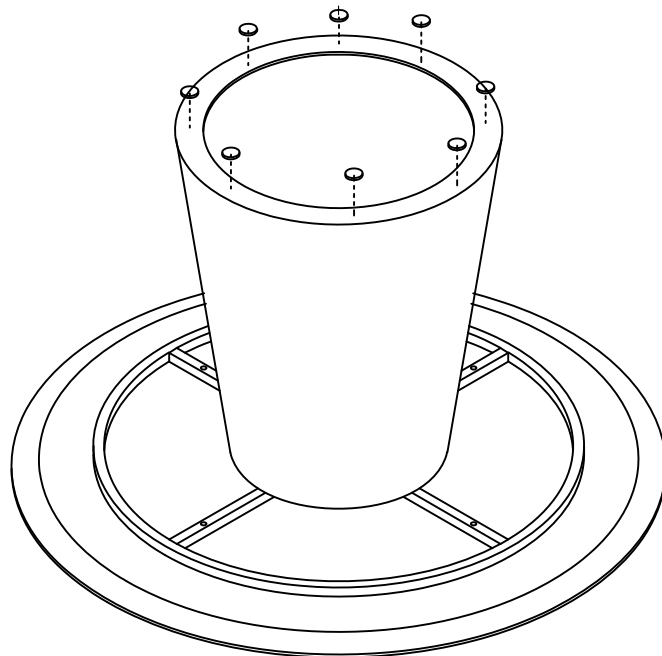

4

