

ASSEMBLY INSTRUCTIONS

Thank you for your purchase. Please follow the instructions for correct assembly. While we took great effort to ensure these assembly instructions were correct at the time of printing, sometimes updates are required post production. For the most up to date versions please refer to the product page on our website. www.adairs.com.au www.adairs.co.nz

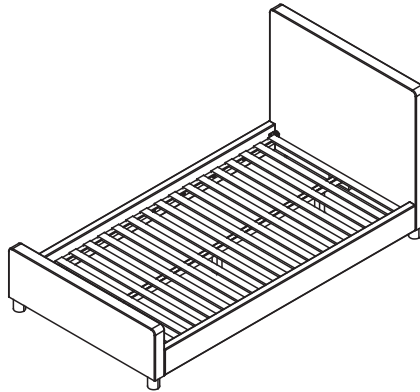

IMPORTANT! KEEP FOR FUTURE REFERENCE

WARNING. Do not place this child's bed near heat sources, windows and other furniture.

WARNING. Do not use this child's bed if any part is broken, torn or missing.

WARNING. Not suitable for children under 4 years.

That the child's bed conforms to BS 8509:2008 + A1: 2011.

Model number: 59425.

The recommended age for this set is 4-12 years.

RECOMMENDED MATTRESS SIZE

This bed has been manufactured for use with a mattress which measures 1070 mm wide by 2030 mm long and 100 mm in thickness.

The bed is designed to be dismantled for storage or transportation.

All assembly fittings should always be tightened properly and checked periodically.

CLEANING AND MAINTENANCE

Regularly check all screws for tightness or damage that could render the bed unsafe. To clean, use a damp cloth, avoiding the use of detergents or abrasives.

That children are likely to play, bounce, jump and climb on beds, therefore the child's bed should not be placed too close to other furniture or windows, blind cords, curtain pulls or other strings or cords," and should be placed either tight to any wall or have a gap of 300 mm between the wall and the side of the bed.

Where luminaires are included as part of the child's bed, a warning about electric shock and/or heat sources.

Any additional or replacement parts are obtained from the manufacturer or distributor.

ASSEMBLY INSTRUCTIONS

PARTS INCLUDED

- | | |
|-----------------------|-------|
| 1. Headboard | :1pc |
| 2. Footboard | :1pc |
| 3. Leg | :4pcs |
| 4. Side rail | :2pcs |
| 5. Center rail | :1pc |
| 6. Middle support leg | :3pcs |
| 7. Mattress base | :1pc |

①

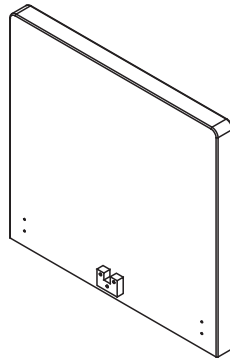

②

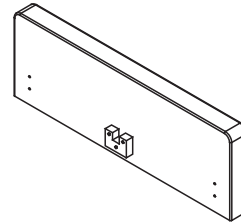

③

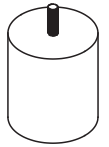

④

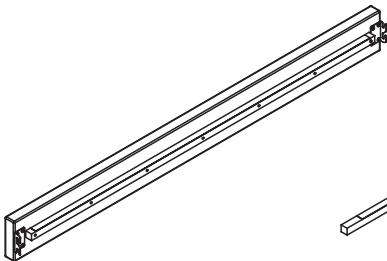

⑤

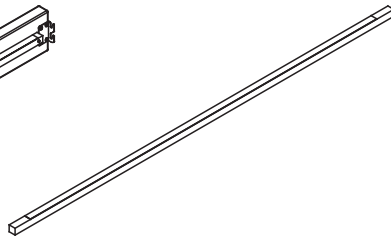

⑥



⑦

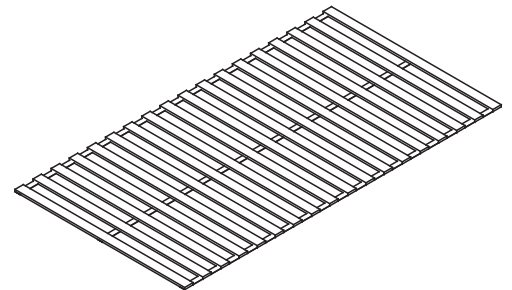

HARDWARE INCLUDED



WARNING

This package contains small parts.
Keep away from children until assembled.

- | | |
|----------------------|-------|
| A. Bolt | :8pcs |
| B. Flat washer | :8pcs |
| C. Split lock washer | :8pcs |
| D. Allen key | :1pc |

Ⓐ

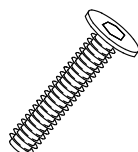

Ⓑ



Ⓒ



Ⓓ

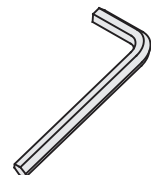

ASSEMBLY INSTRUCTIONS

STEP 1

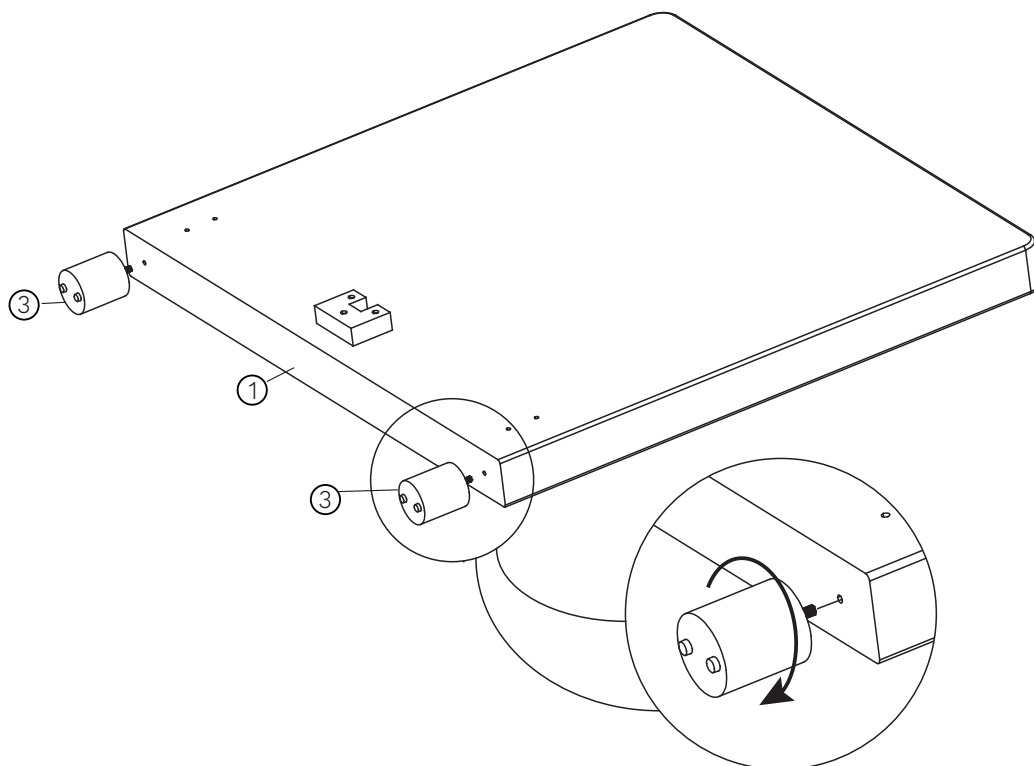

STEP 2

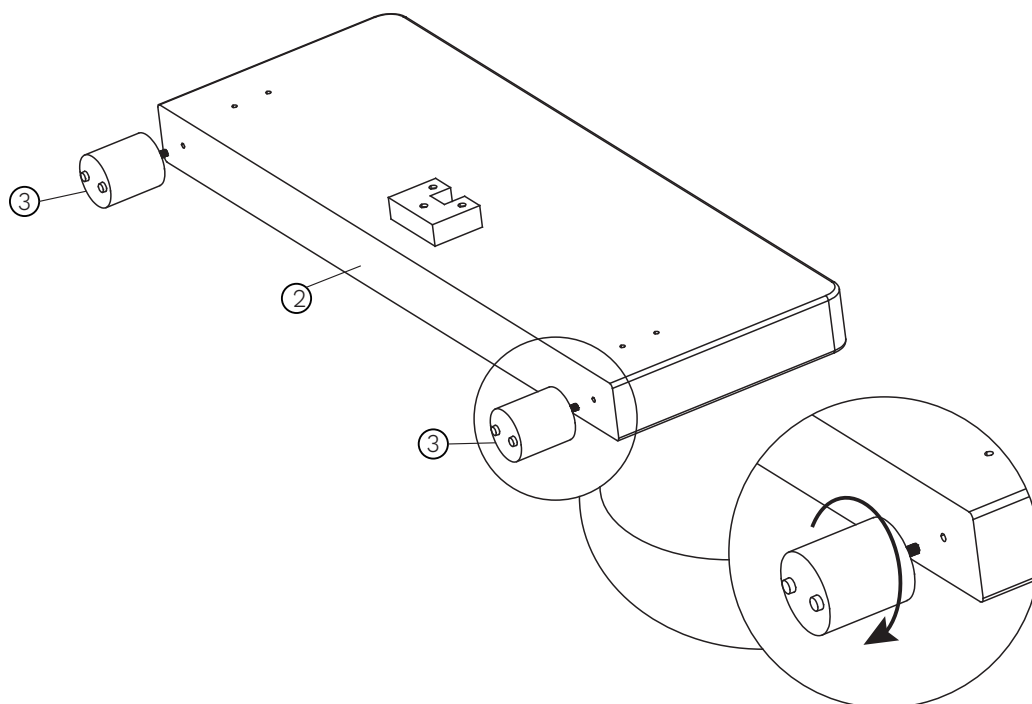

ASSEMBLY INSTRUCTIONS

STEP 3

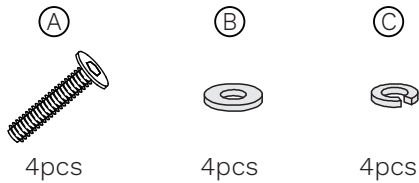
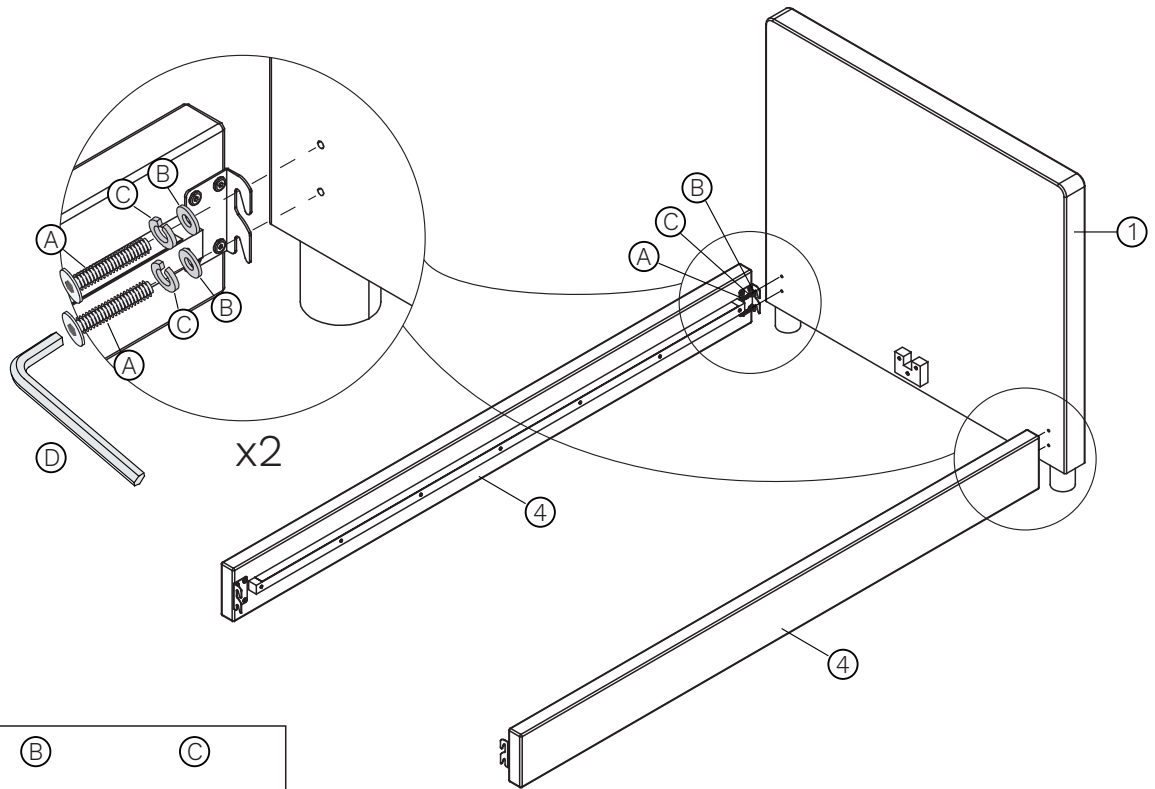

STEP 4

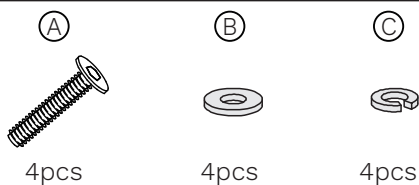
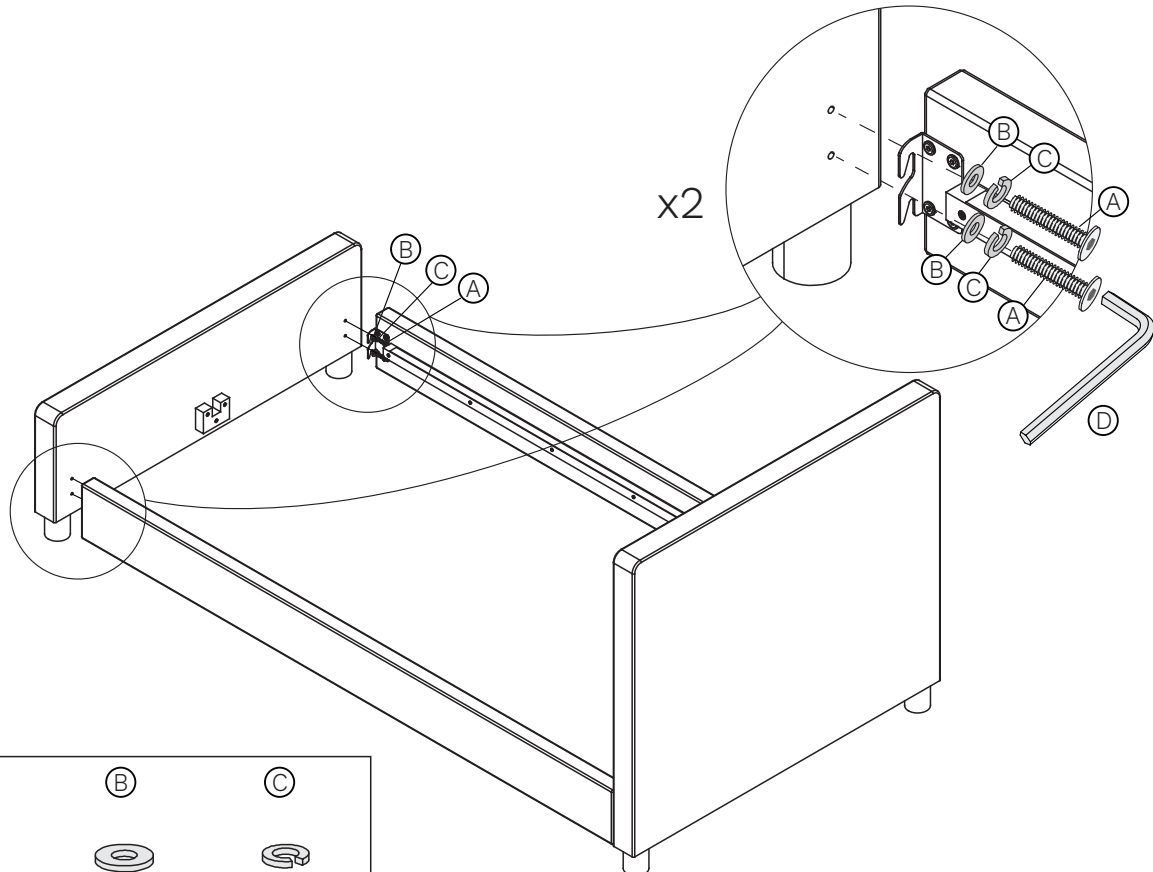

ASSEMBLY INSTRUCTIONS

STEP 5

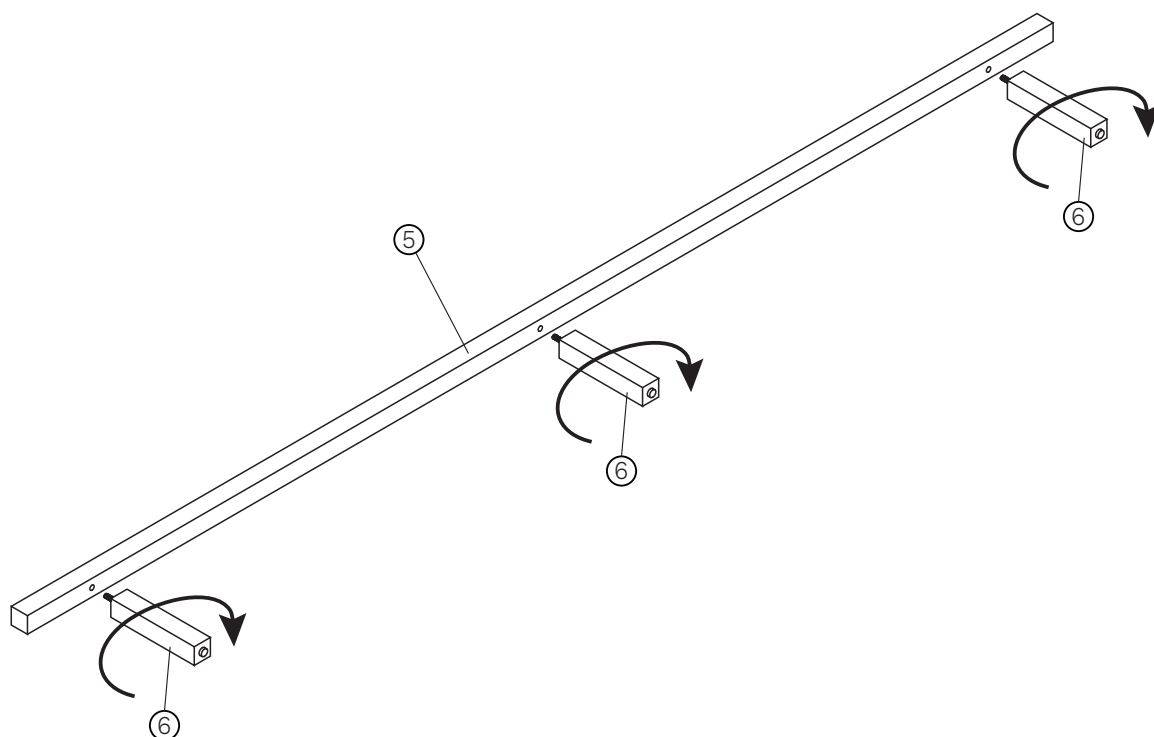

STEP 6

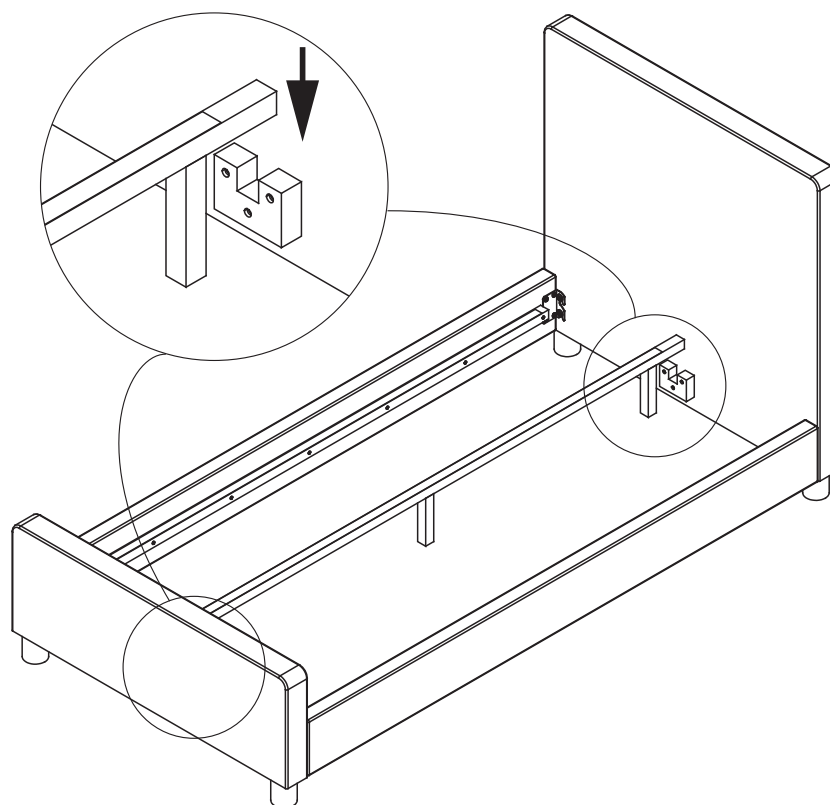

ASSEMBLY INSTRUCTIONS

STEP 7

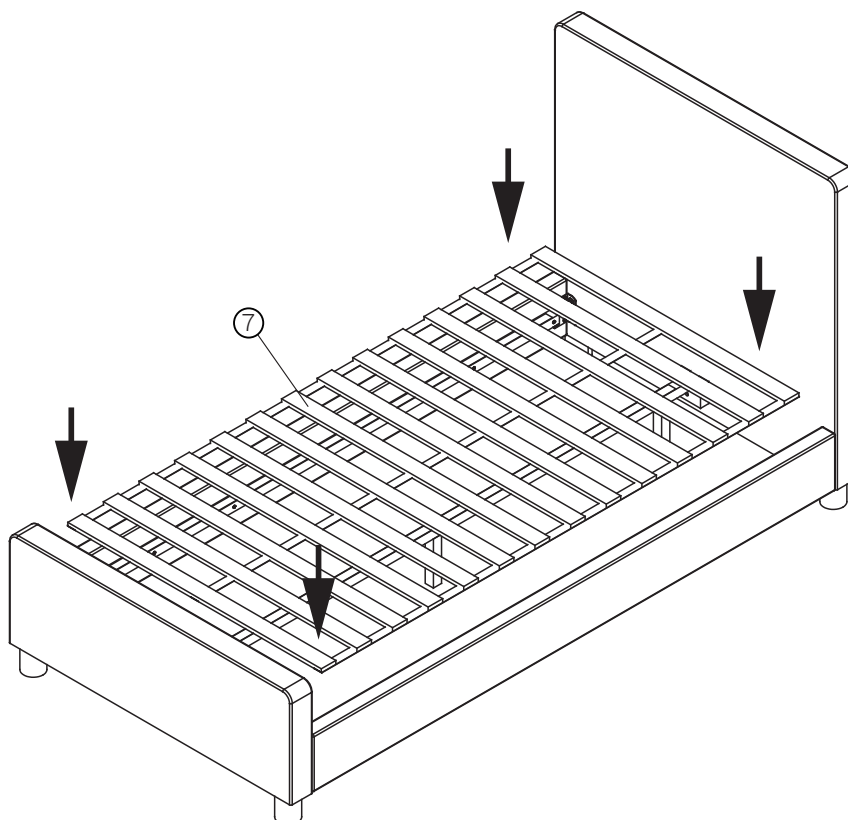

STEP 8

